

The Courses & distances  
down Little Juniata from  
the Post to the post

- are S 18½ E 58
- S 25 E 22
- S 70 E 12.9
- NS 82½ E 56
- S 83½ E 41.7 pt

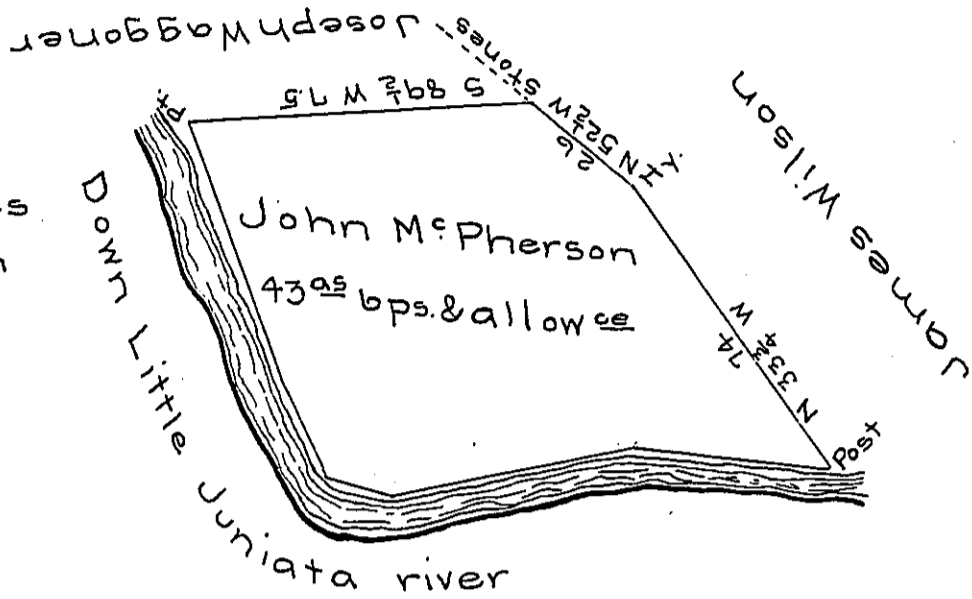

Situate in Franklin township Huntingdon County containing forty three acres bperches & allowance of six per cent for roads &c. surveyed the 16<sup>th</sup> day of March 1833 in pursuance of a warrant granted to John M. Pherron dated Sept<sup>r</sup> 17<sup>th</sup> 1832.

W<sup>m</sup> Reed D.S.

To Jacob Spangler Esq. }  
Surveyor General }

*IN TESTIMONY* that the above is a copy of the original remaining on file in the Department of Internal Affairs of Pennsylvania, made conformably to an Act of Assembly approved the 16th day of February, 1833, I have hereunto set my Hand and caused the Seal of said Department to be affixed at Harrisburg, this first day of March 1906

*Loach B. Brown*  
Secretary of Internal Affairs.